



Shark Navigator Lightweight Upright Hose Replacement

This guide will show how to properly remove the vacuum hose from the Shark Navigator Lightweight Upright.

Written By: Kahye Yu



INTRODUCTION

A damaged hose will not allow the vacuum to work properly. This guide will show how to detach the hose from the vacuum.

Step 1 — Hose



- Locate the upper connection of the hose found directly below the base of the handle. Push in the the tab on the outside of the tube with your thumb.
- Pull down on the tube while maintaining pressure on the tab.
- Separate the upper connection of the tube from the housing, releasing the hose.

Step 2

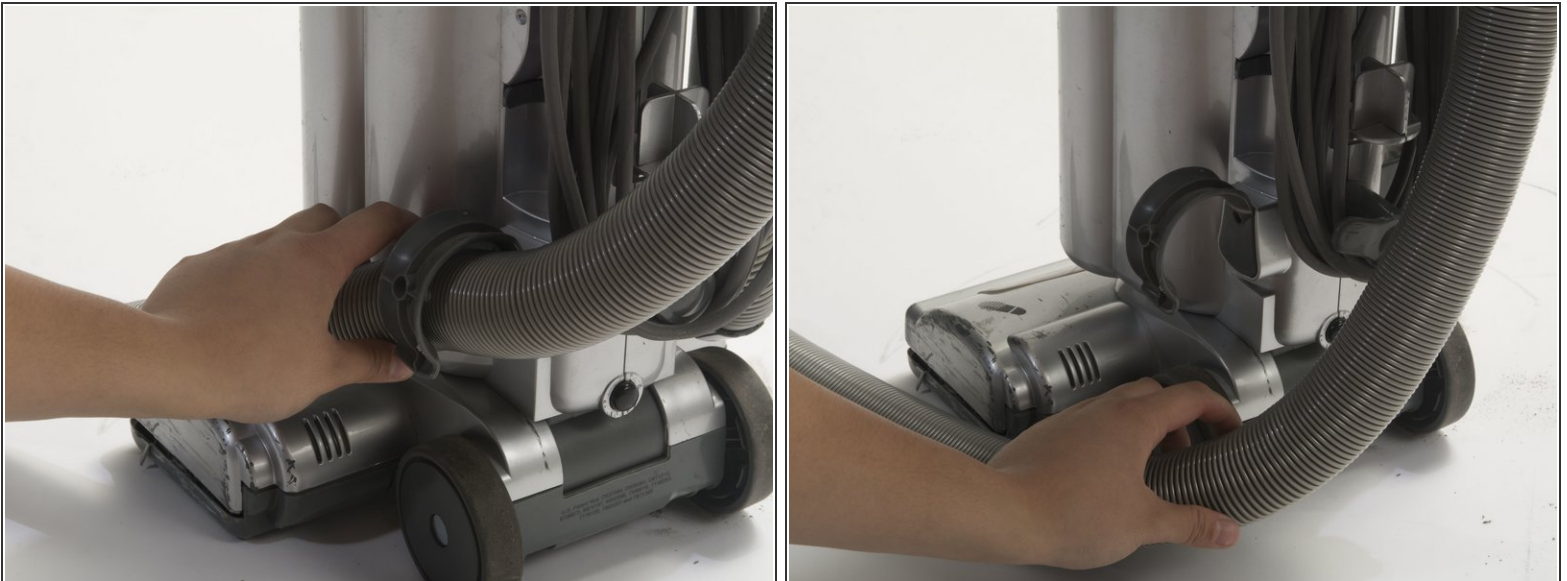

- Locate the lower attachment of the hose found in the bottom left corner.
- Pull the hose down towards the floor, releasing the hose from the hose guide.

Step 3

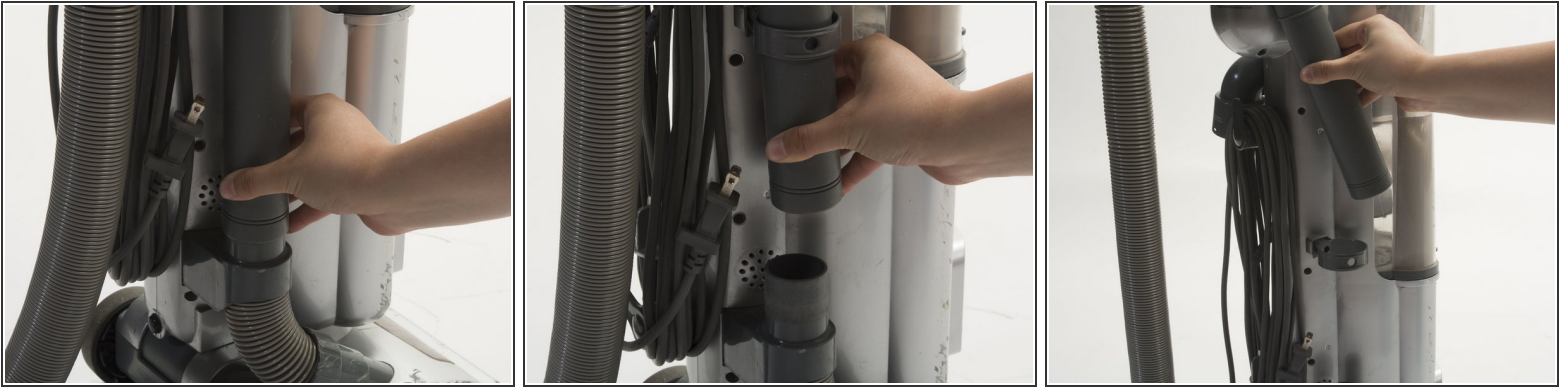

- Pull up on the hose pipe located on the right side of the vacuum firmly.
- Lift the hose pipe upwards and all the way through the plastic guide ring.

To reassemble your device, follow these instructions in reverse order.