



Toshiba Satellite A105-S4074 Battery Replacement

Replacing the battery of the Toshiba Satellite A105-S4074 should it no longer hold a charge.

Written By: Ryan Bortnick



INTRODUCTION

After diagnosing your Toshiba Satellite A105-S4074, should you conclude that the battery is faulty and will need to be replaced, these simple and easy to follow instructions will guide you through the process.



PARTS:

- [Denaq 6-Cell Lithium Ion \(Li-Ion\) Battery for Toshiba Satellite A105-S4074](#) (1)
-

Step 1 — Battery



 To prevent electrical shock, make sure the computer is turned off; and disconnect the power adapter from the computer and electrical outlet prior to beginning any repairs on this device.

- Turn the laptop upside down with the battery facing you.

Step 2

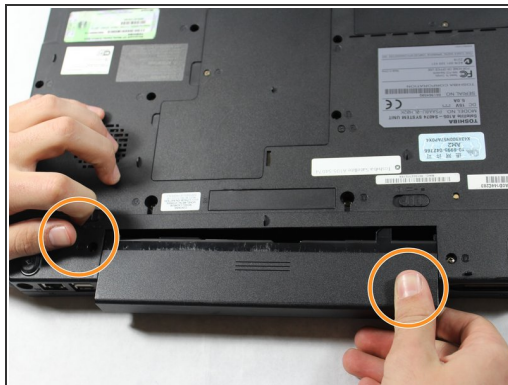

- Slide both the left and right battery release tabs outwards away from center of the laptop.
 - ⓘ Right release tab will remain locked in place.
- While still holding the left release tab, slide the battery towards you using your right hand.
- Fully remove the battery from the laptop.

To reassemble your device after inserting the replacement battery, follow these instructions in reverse order.