



Kodak Easyshare P712 Memory Card Replacement

This guide demonstrates how to replace the memory card.

Written By: Melanie Martin





PARTS:

- [16 GB SD Card](#) (1)
-

Step 1 — Power Camera Off



- Turn off the camera by turning the selector dial to “off.” This is located on top of the camera body.

Step 2 — Open Door

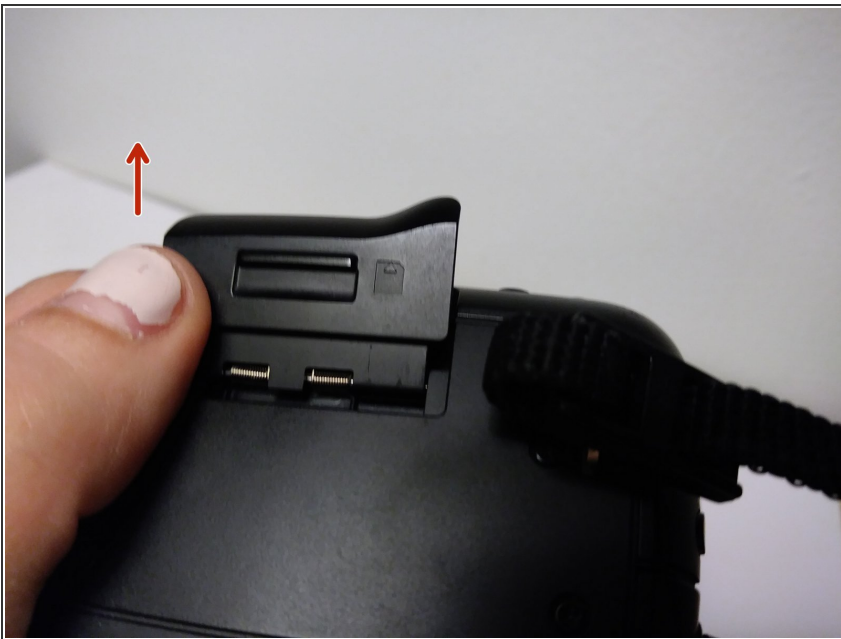

- Locate memory compartment on the side of the camera body and slide open by applying pressure in the

direction of the arrow. Door will spring open.

Step 3 — Insert/Remove Memory Card



- Insert memory card (SD card) with the gold terminals facing downward. Gently press down until you feel it lock into place. Note: To remove a memory card, apply pressure down until you feel it click. Then it should pop up and you can just pull it out. Close memory compartment door.

To reassemble your device, follow these instructions in reverse order.