

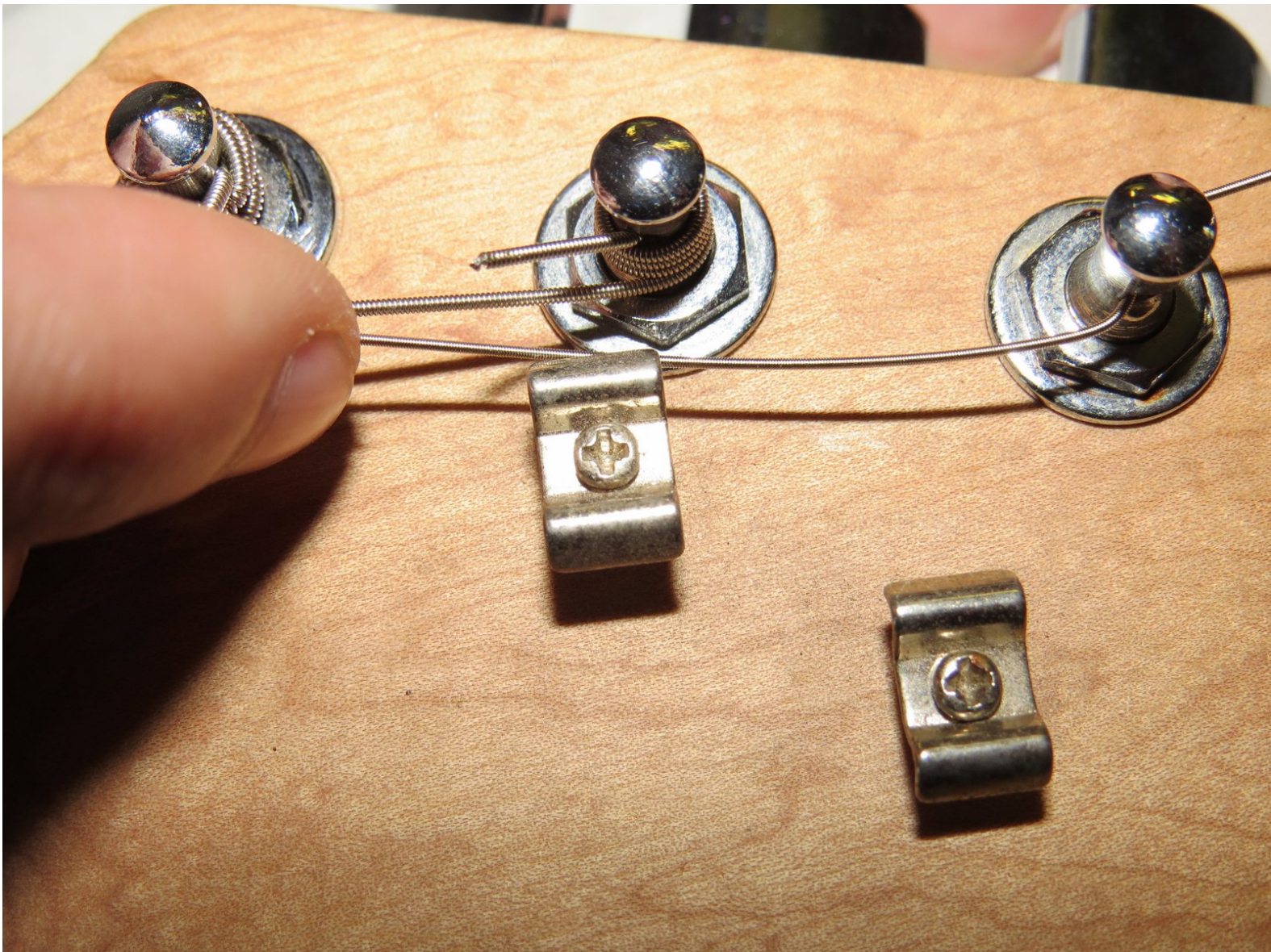

Fender Starcaster String Replacement

How to install new strings on a Starcaster by Fender electric guitar.

Written By: Jasper Fleischhauer



INTRODUCTION

There are many different styles of tuners and bridges, therefore, many different methods of replacing the strings. This Starcaster has a string-through bridge and standard in-line tuners, so the string changing process is fairly simple.



TOOLS:

- [Small Needle Nose Pliers](#) (1)
- [Flush Cutter](#) (1)



PARTS:

- [New strings](#) (1)
String gauge is based upon personal preference.

Step 1 — Loosen the Strings



- Start by loosening the strings. This is done by turning the tuning knob until the string has lost tension.
- Repeat this for all six strings on the guitar.

Step 2 — Remove the Strings from the Tuning Pegs



 Be mindful of the string ends. They may be sharp and could puncture your skin.

- It may be necessary to use pliers to remove string ends from the tuning peg.

Step 3 — Remove the Strings from the Bridge

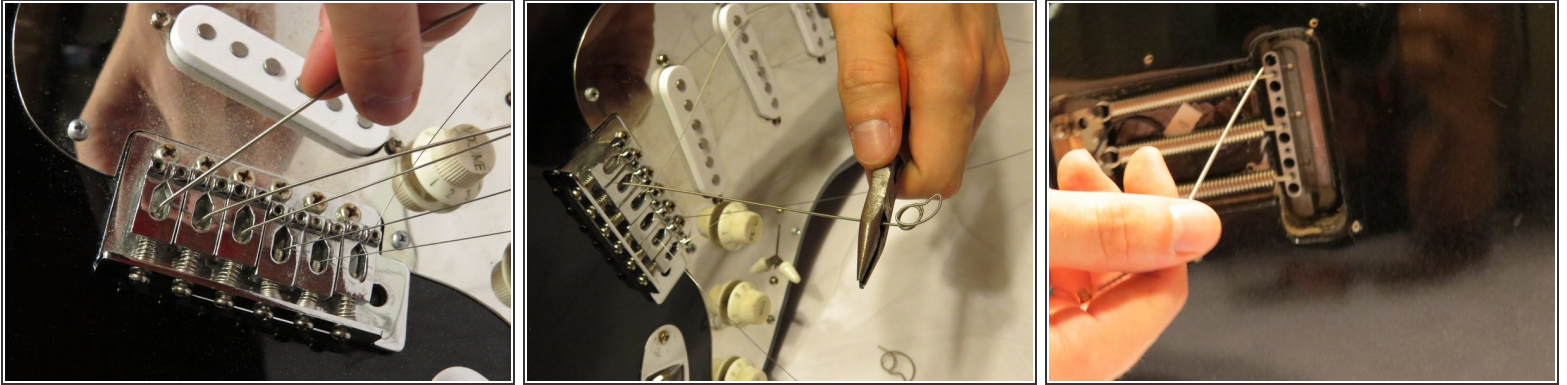

- After removing the strings from the tuning pegs, slide the strings through the bridge and out of the back of the guitar.
- If the twists in the string ends are in the way, use wire cutters to snip them off. This will allow the heavier strings to pass through the bridge easier.

Step 4 — String

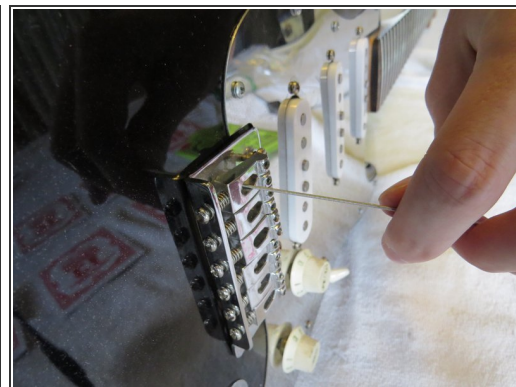
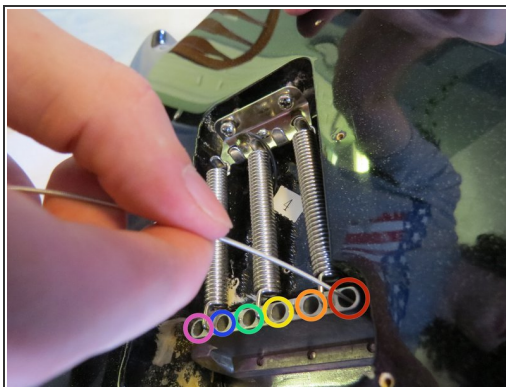

- Take any one of the new strings and slide it through the appropriate bridge hole.
 - ❗ The replacement strings used on this guitar were "Regular Slinky" by Ernie Ball, which is a 10 gauge string set.
- 6th String: E - 46 Gauge
- 5th String: A - 36 Gauge
- 4th String: D - 26 Gauge
- 3rd String: G - 17 Gauge
- 2nd String: B - 13 Gauge
- 1st String: E - 10 Gauge

Step 5

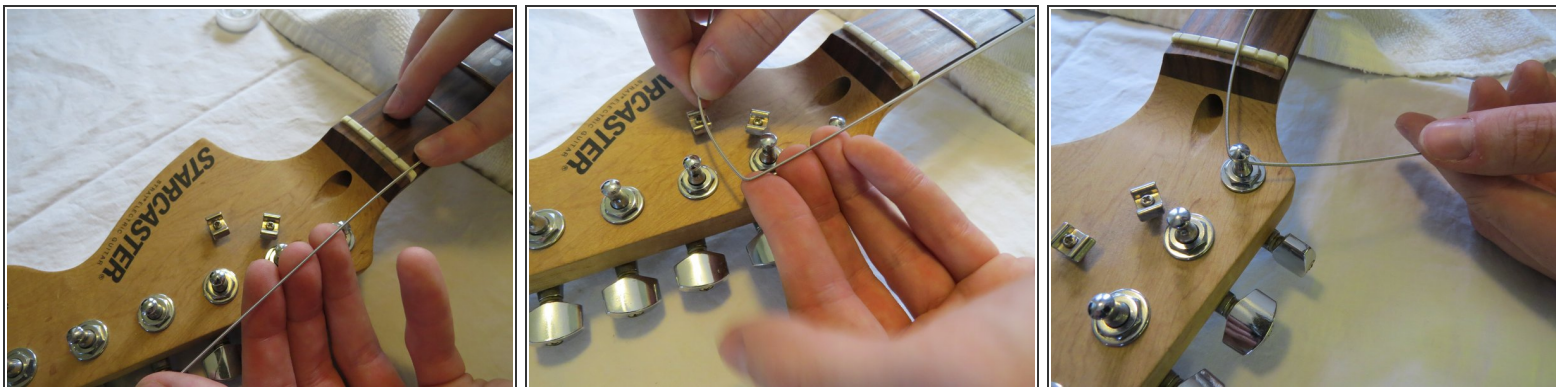

- Lay the string parallel to the guitar's neck and directly over the appropriate tuning peg.
- Measure a "three finger's length" (about 1.5") on the string passed the tuning peg.
- Make a sharp bend in the string at where you measured 1.5" passed the tuning peg.
- Turn the tuning peg until the string hole faces perpendicular to the guitar's neck.
- Feed the bent string into the tuning peg until the bend meets the tuning post.

Step 6



- Make another sharp bend in the string on the outside of the tuning post.
- Turn the tuning key counter clockwise while applying light pressure to the string on the inside of the post.
- Wrapping the string around the post will help the string stay in-tune longer.
- If the wraps of the string around the post start to roll over the top of the post, hold them down while still turning the post.
- Continue turning the post until at least 2 full wraps of the string have been made around the post.

Step 7



- Snip the excess string off from the post with a wire cutter (leaving at least half an inch of string left).

Step 8

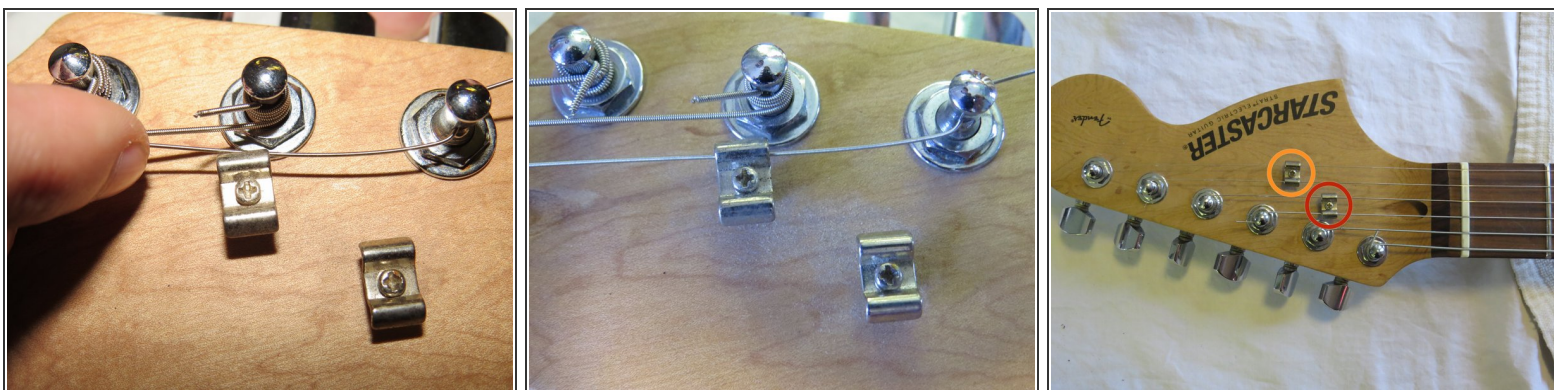

- Continue installing strings using the the same method described in the last few steps.
- The last four strings (the D, G, B, and E strings), must be guided underneath the two "string trees" in the center of the headstock.
- String Tree for the D and G strings
- String Tree for the B and E strings
- Tune the strings to your desired pitch and your guitar is ready to play!

To reassemble your device, follow these instructions in reverse order.