



Black and Decker JE2200B Saftey Locking Latches Replacement

This guide will help users replace old or broken safety locking latches. These latches hold various juicer pieces in place.

Written By: AvaAnne Hogue



This document was generated on 2020-11-13 09:31:31 PM (MST).

INTRODUCTION

The safety latches are an easy component of the juicer to replace. They require minimal tear down to replace and have no safety hazards associated with replacement.



TOOLS:

- [iFixit Opening Tools](#) (1)
-

Step 1 — Saftey Locking Latches

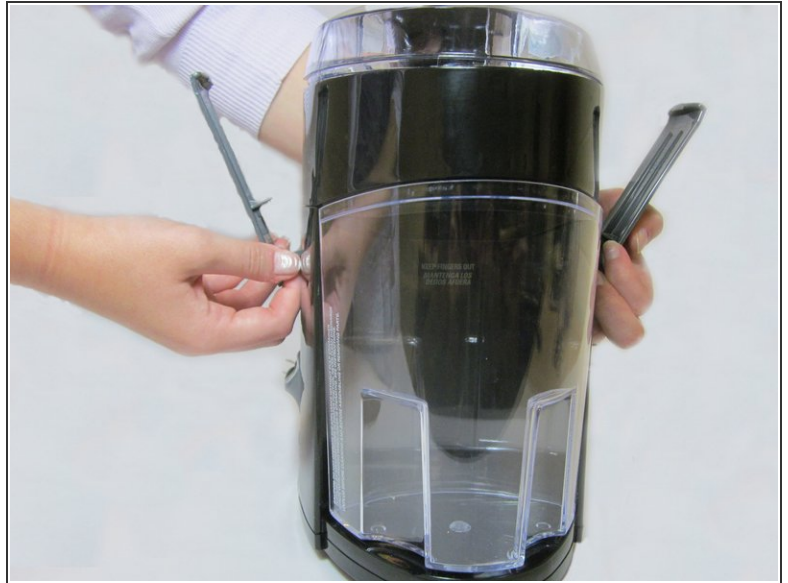

- Unlock the latches on the juicer by places hands under latches and pulling out.

Step 2

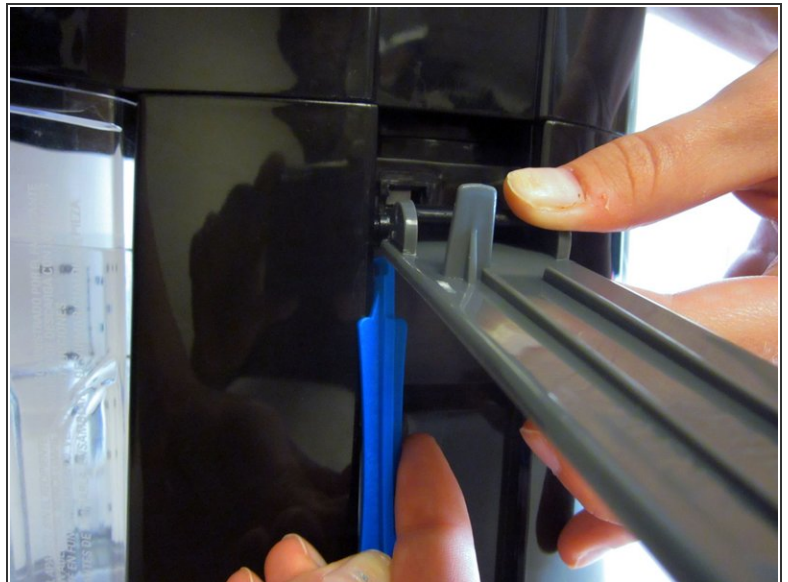

- Grasp the latch close to the juicer with your right thumb and pointer finger and pull to the right.
- With your other hand, take the plastic opening tool and insert it on the bottom of the latch.

Step 3



- Push the tool up to remove the latch.
- Repeat Step 2 for the second safety locking latch.

⚠ Use gentle force to remove the latches from the juicer to avoid damage to the machine.

To reassemble your device, follow these instructions in reverse order.