



Torque King Electric RTR RC Monster Truck

Rear Wheel Suspension Replacement

Replace the suspension of the rear tires in a Torque King RC Monster Truck.

Written By: Colton Sholtis

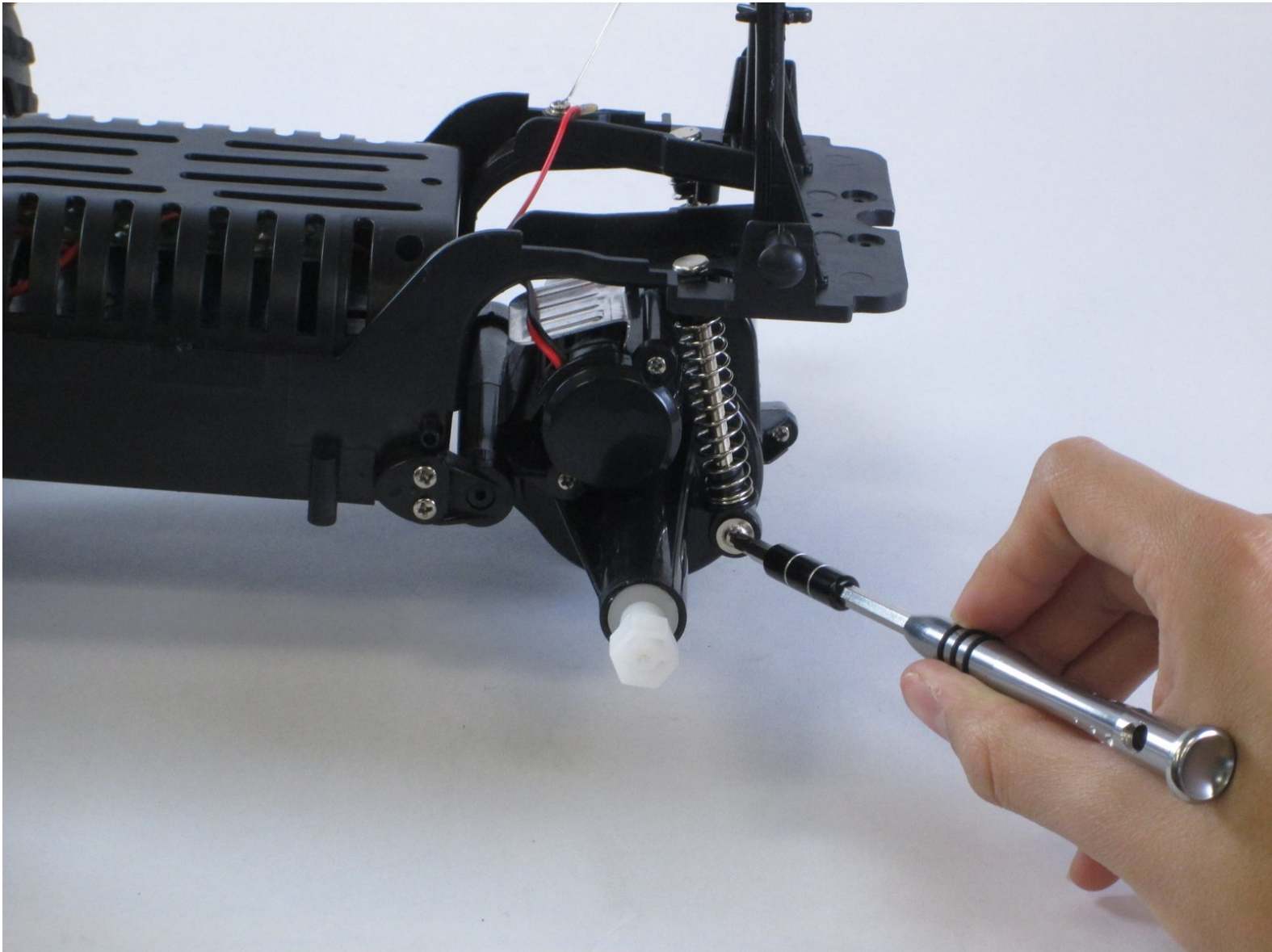

INTRODUCTION

The suspension of the truck is responsible for its steering stability and ability to drive over rough terrain. Through regular use, the springs and rods of the suspension may become damaged; this is a guide to replace those parts.

TOOLS:

- [Phillips #1 Screwdriver](#) (1)
-

Step 1 — Casing



- From the top view, remove each of the four pins that hold the casing in place.

Step 2



- Slowly pull the casing up to remove it.

Step 3 — Removing Screws

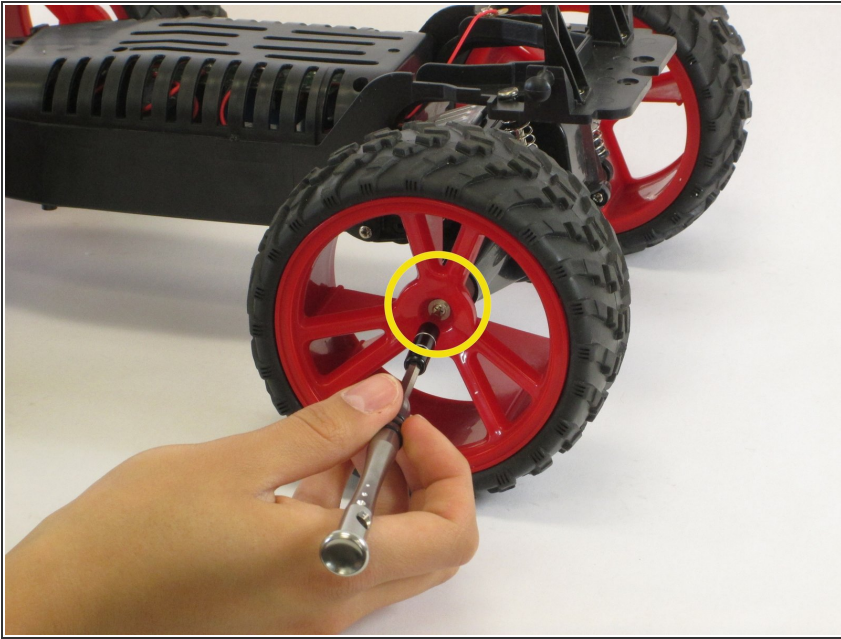

- Using a Phillips 1 screwdriver, completely unscrew the 8mm screw located in the center of the wheel. Repeat this step for other wheels if needed.

Step 4 — Removing the Wheel

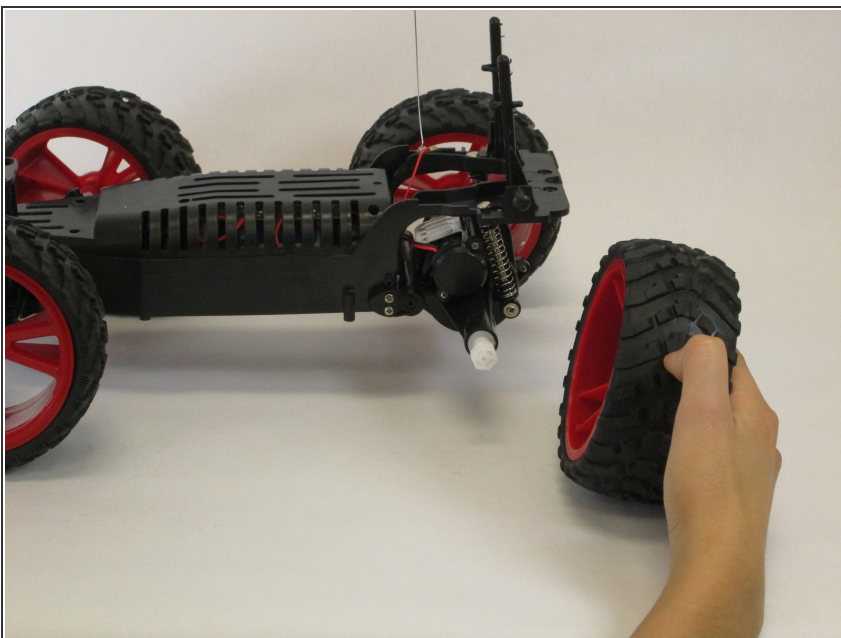

- Carefully pull the wheel off of its axle. Repeat for other wheels as necessary.

Step 5 — Rear Wheel Suspension

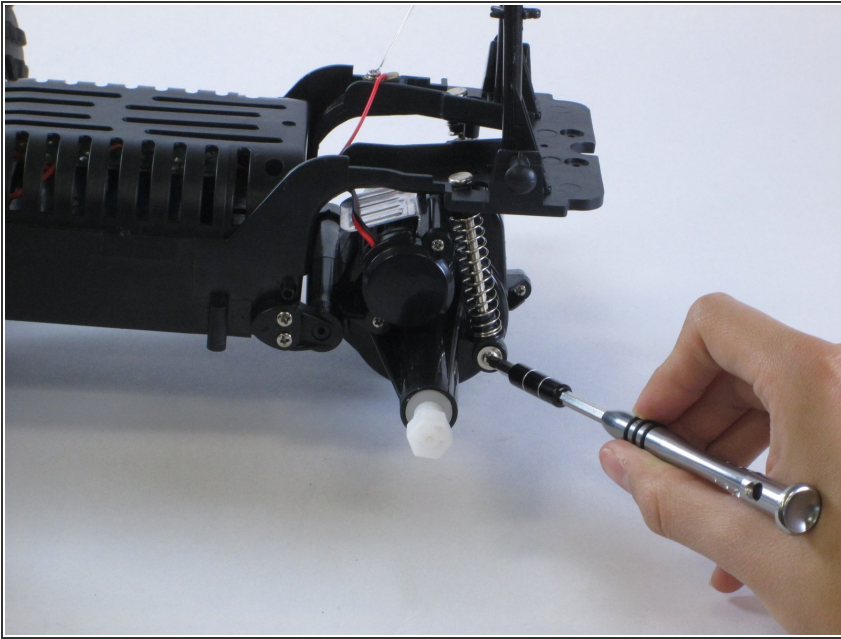

- After removing the rear wheels, remove the 8mm screw under each spring with a Phillips 1 screwdriver.

Step 6

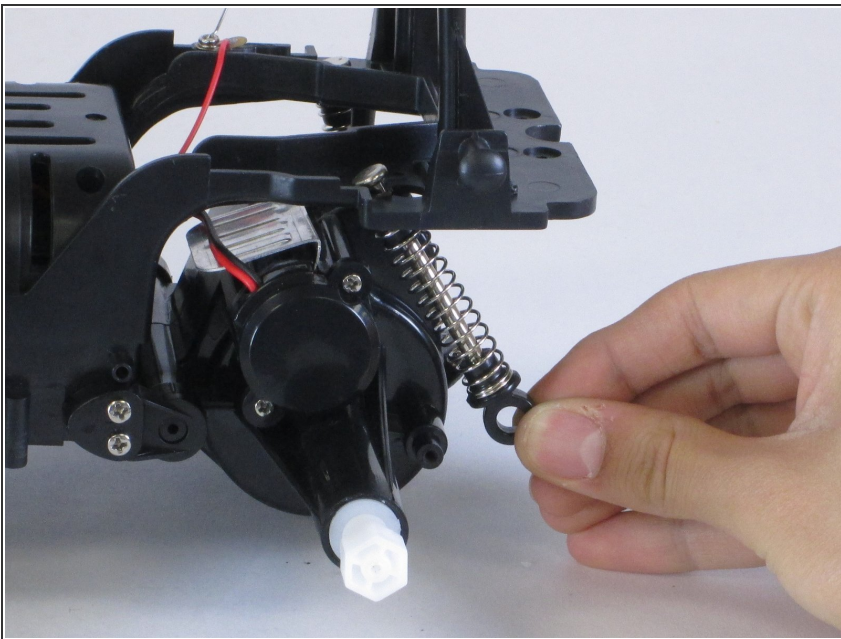

- Slide off the bottom part of the rod connected to the chassis.

Step 7

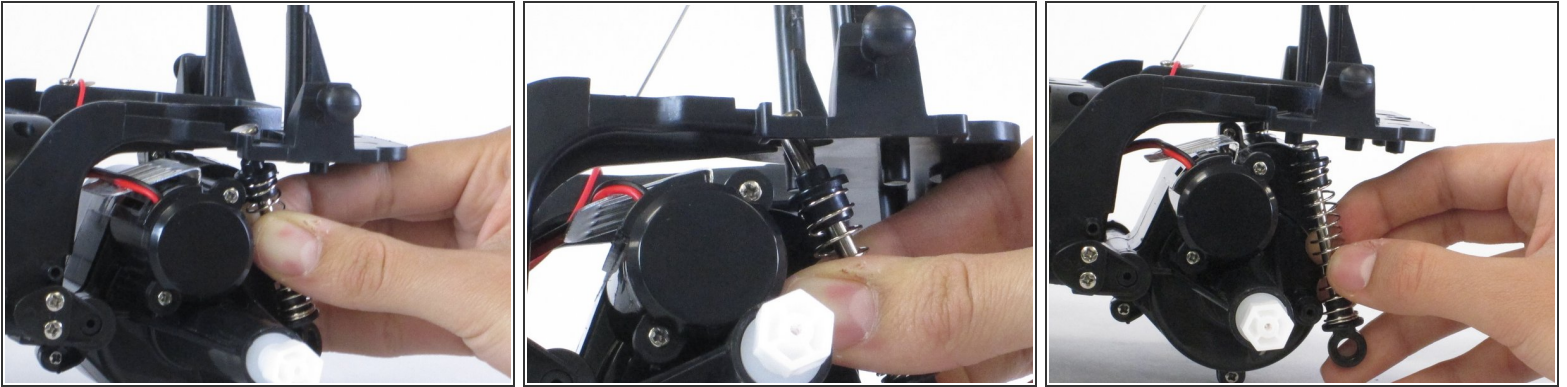

- Pull the black washer inside the spring downwards and towards the truck's rear simultaneously in order to remove the suspension.

To reassemble your device, follow these instructions in reverse order.