



# Planet Eclipse Etha Bolt O-rings Replacement

This guide will demonstrate how to disassemble the bolt in order to replace the O-rings within.

Written By: nicholasj6



## INTRODUCTION

Sometimes, the O-ring seals in the Etha's bolt can get worn out and need to be replaced. Fortunately, Planet Eclipse designed this part of the marker to be taken apart and put back together with ease.



### TOOLS:

- [Macro Bit Set](#) (1)
- [Smart Wrench](#) (1)



### PARTS:

- [Replacement O-rings](#) (1)  
*Included with your marker from the factory.*

## Step 1 — Bolt O-rings



- Using the 1/4" hex key, turn the bolt counterclockwise and remove.

## Step 2



- Slide the bolt tip and spring off of the main assembly.
- ⓘ Keep a towel handy, you may get some grease on your hands.



### Step 3



- Unscrew the casing from the rest of the bolt.
- ⓘ Again, you may get some grease on your hands during this step.

### Step 4



- Grab the flat surface shown.
- Unscrew this portion counter clockwise to remove it.
- ⓘ If you're having trouble unscrewing the part, try using a small wrench.

## Step 5

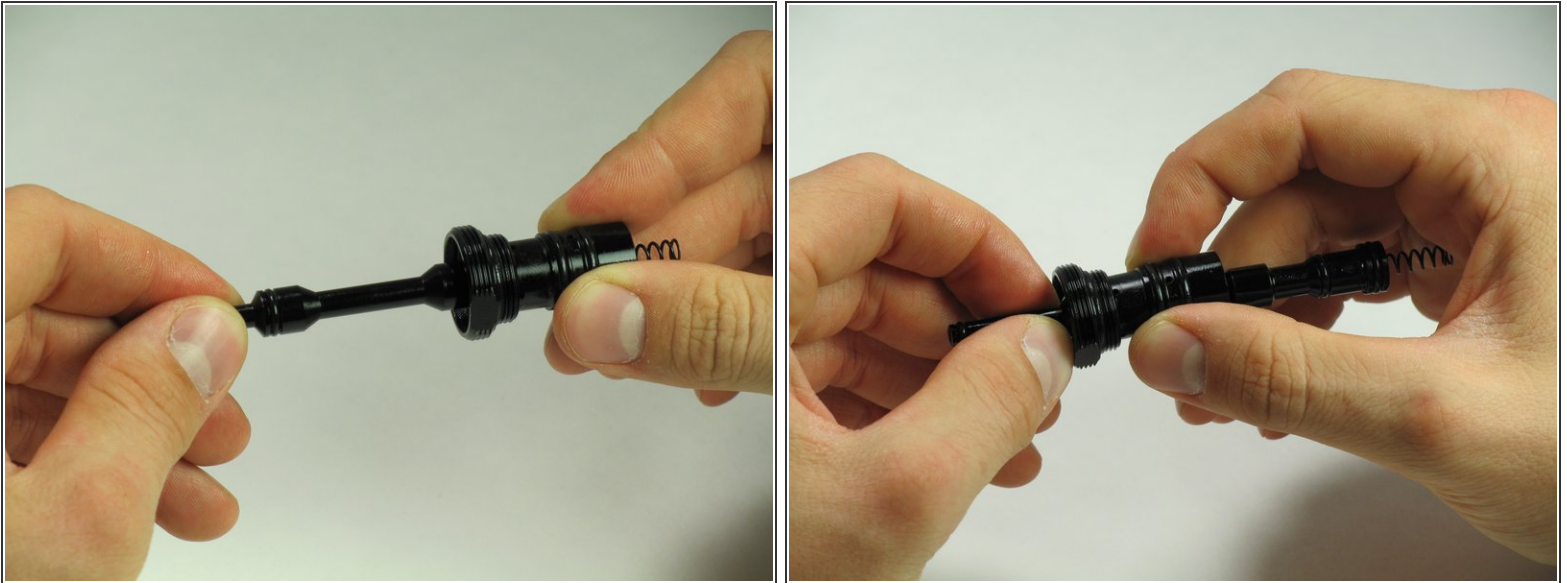

- Grab the threaded cover and slide it away from the spring.
- ⓘ The bolt should now be in three pieces.
- ⓘ The threaded cover is the same part that you unscrewed in the last step.

## Step 6

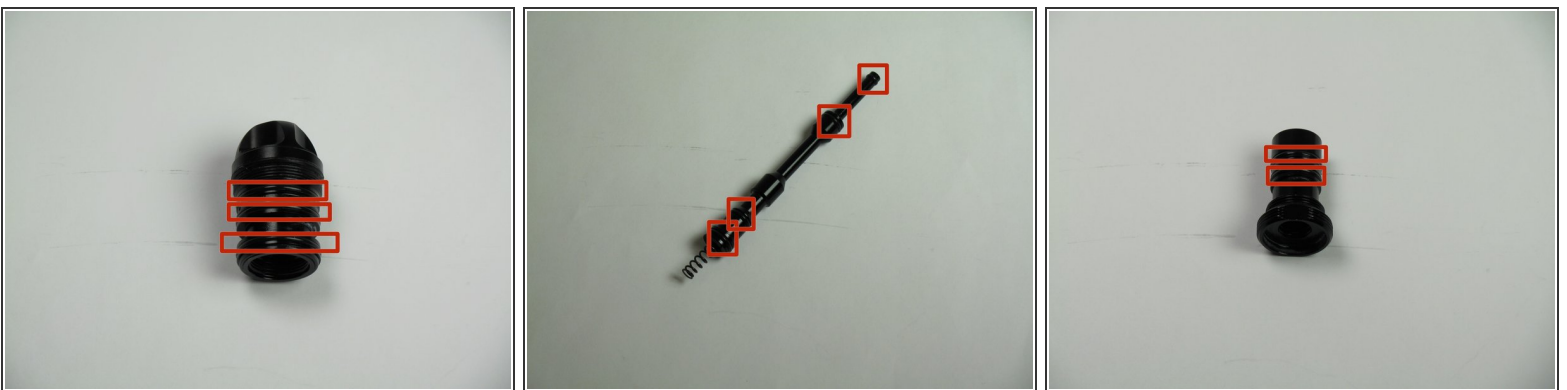

- Replace and lubricate the 9 marked O-rings.
- ⓘ O-ring removal will be explained in the next step.

## Step 7



- Grab the O-ring on the sides.
- Pinch the O-ring upwards to create a gap between the metal and the ring.
- Use a small object to slip into the loop and pull the O-ring off gently.

 We recommend using a small Allen Key for this.

To reassemble your device, follow these instructions in reverse order.