



Samsonite Luggage Wheel Replacement

Use this guide to replace a damaged Samsonite...

Written By: Xinyi Min



INTRODUCTION

Use this guide to replace a damaged Samsonite luggage wheel.

A damaged wheel may stick, causing the suitcase to veer off course, or preventing the suitcase from moving. A replacement wheel will help you fix the problem.

Step 1 will help you ensure that a replacement is needed and prepare for the replacement.

Step 2 will help you select the correct replacement part.

TOOLS:

6-in-1 Screwdriver (1)

Step 1 — Wheel



- Clean the wheel to make sure that the wheel is not stuck.
- ① Sometimes wheels don't work because they're caked with dirt or debris. This step can help you make sure that it needs to be replaced.

Step 2



- Select the right replacement by measuring the diameter and width of the wheel.

Step 3



- Remove the screws securing the wheel clip inside the case.

Step 4



- Pull out the clip securing the wheel to the case.

Step 5



- Remove the old wheel from the outside of the case.

Step 6



- Insert the new wheel onto the luggage, making sure that the tubes on the wheel base align with the holes in the luggage.

Step 7

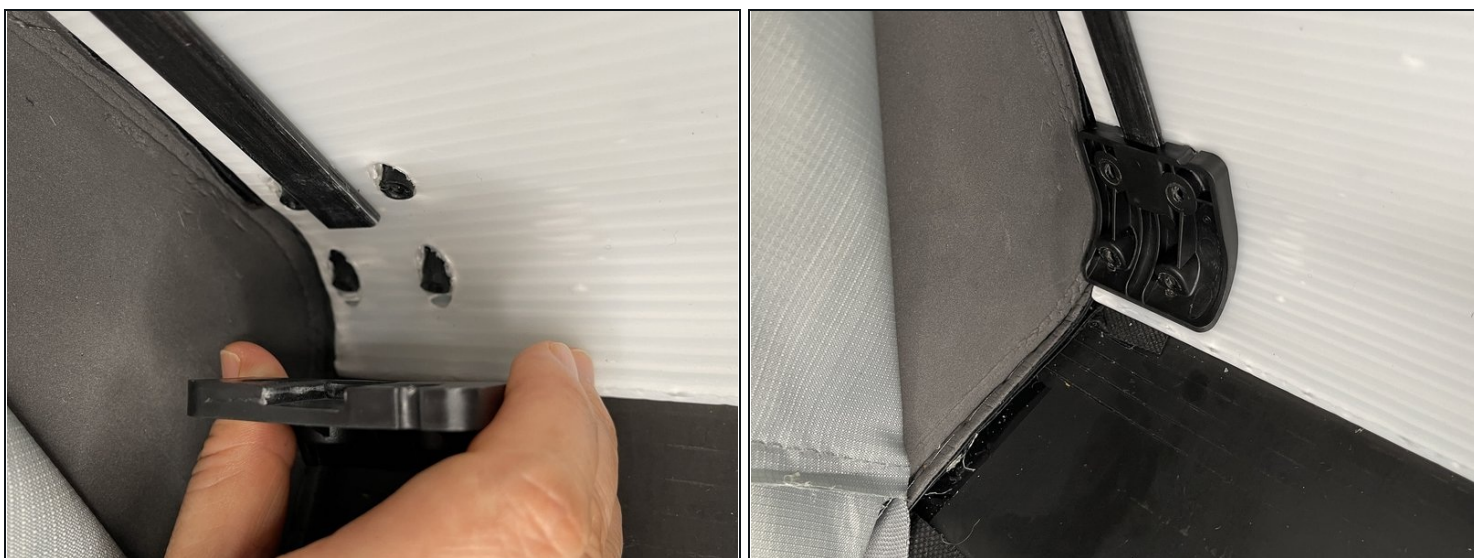

- Put the clip back to its original position inside the case.

Step 8

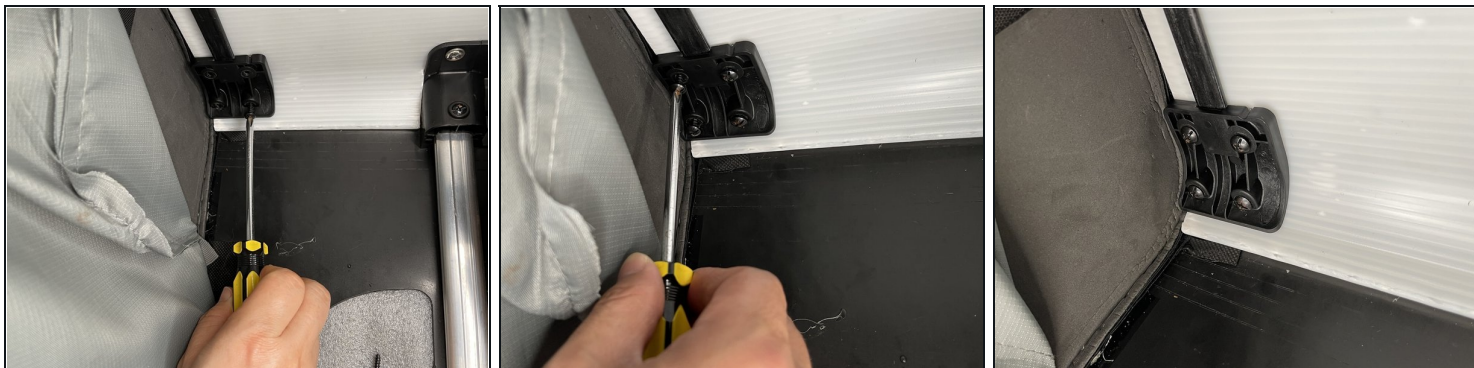

- Tighten the screws that hold the clip back in place.
-