



# Hamilton-T1 Air Intake and Fan Filter Replacement

The servicing or replacement of the filters associated with the Hamilton-T1.

Written By: Trevor Foley



## INTRODUCTION

This guide was created to assist in either the replacement or maintenance of the various filters contained within the ventilator. Regular checks and maintenance will allow for smooth operation of the ventilator.

### NOTES:

- The side fan filter and rear intake filter can be replaced or washed with soap and water before reuse
- The HEPA filter must be replaced



### TOOLS:

- [Phillips #0 Screwdriver](#) (1)
-

## Step 1 — Air Intakes and HEPA Filter

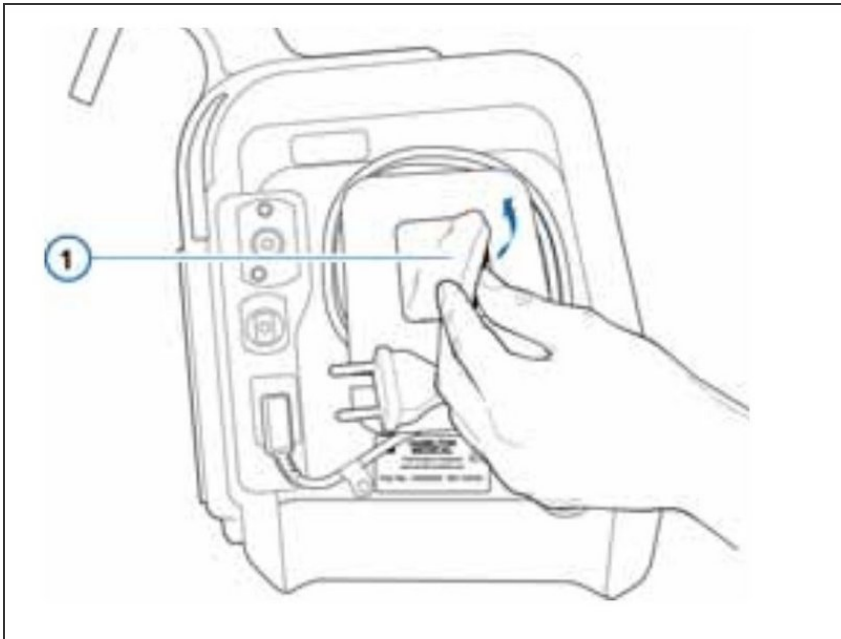

- The fan filter is located on the side of the ventilator and can be removed and replaced by hand.

## Step 2

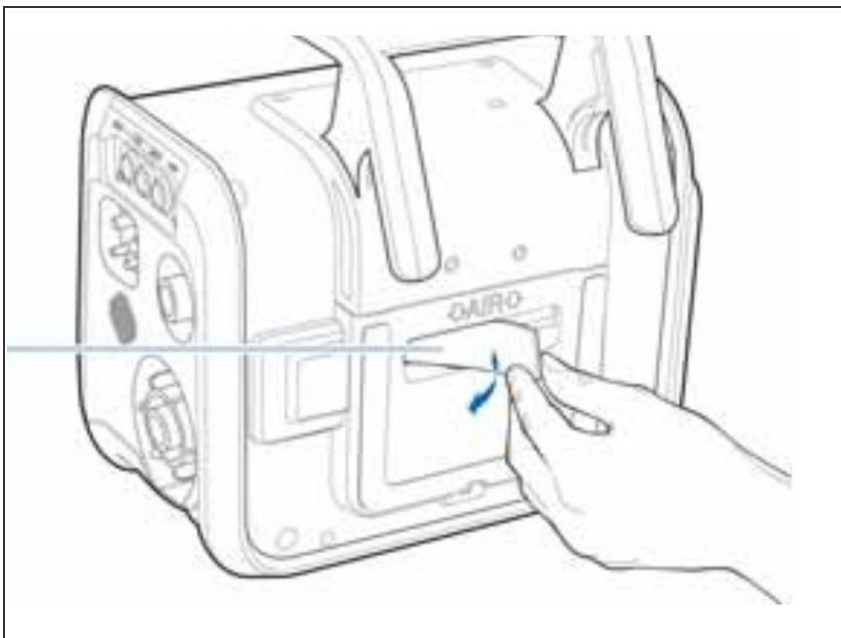

- The air intake filter is located on the rear of the device, and can also be removed by hand.

### Step 3

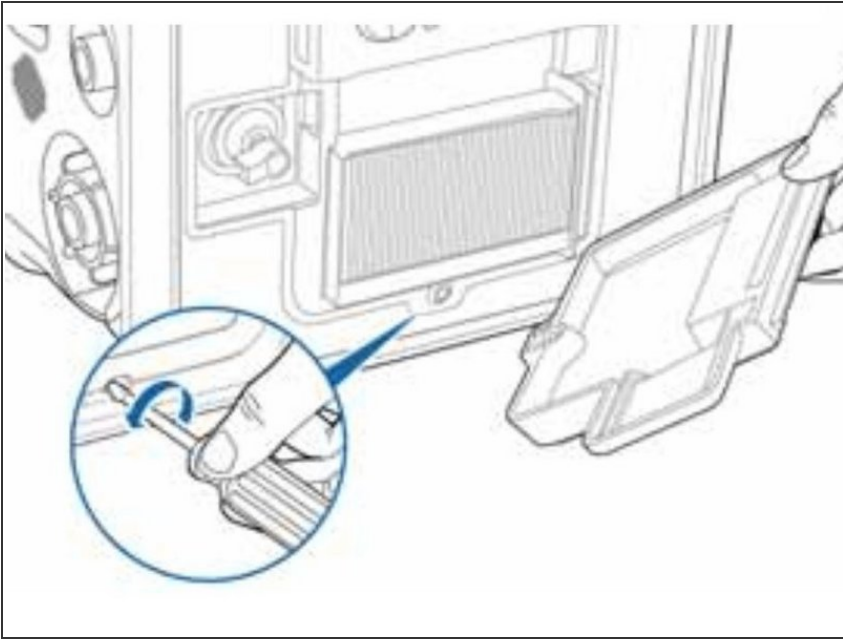

- To access the HEPA filter, first remove the screw holding the filter cover in place and gently remove the cover.

### Step 4

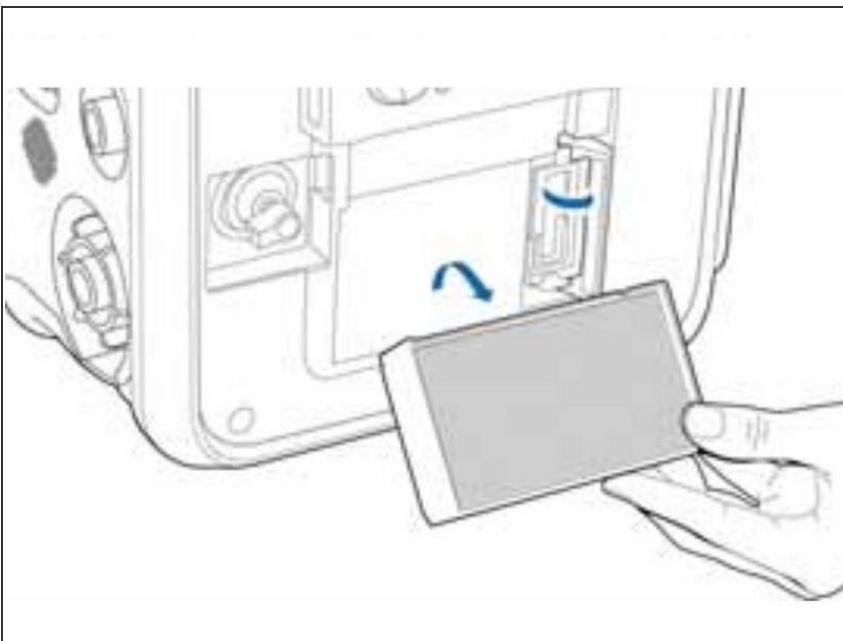

- The HEPA filter can now be removed by hand.
- Install a new HEPA filter and reattach the back panel.
- Be sure to test the device and ensure airflow through all filters before use.

To reassemble your device, follow these instructions in reverse order.