



Longboard Bearing Replacement Guide

This guide will go through the steps of replacing worn down longboard bearings in easy to follow steps.

Written By: AnnaMaria Summer



INTRODUCTION

In this guide, an Enkeeo Longboard was used. This guide should be used to replace the bearings on similar longboards with new bearings. You can also clean existing bearings or replace other parts, like wheels, washers, or spacers.

The bearings of the longboards keep the wheels rotating freely, with minimal friction. It is important to replace worn out longboard bearings because if they fail it can lead to an unexpected crash. If you have faulty bearings, like after an incident, this is the perfect guide to use. Also, have spare parts and be sure you are using the same sized bearings. Some boards can have a different size bearing.

The video below shows step-by-step how to replace bearings: <https://www.youtube.com/watch?v=W6FUcvZj...>



TOOLS:

- Skate Tool (1)



PARTS:

- Longboard Bearings (1)
One set includes 8 bearings, 2 for each wheel

Step 1 — Longboard Bearings



- On a flat surface, unscrew the nut that holds the wheel on the axle using the correct size from the skateboard tool (1/2" size, typically the smaller of the 2 on the top of the 'T') and turning to the left.

Step 2

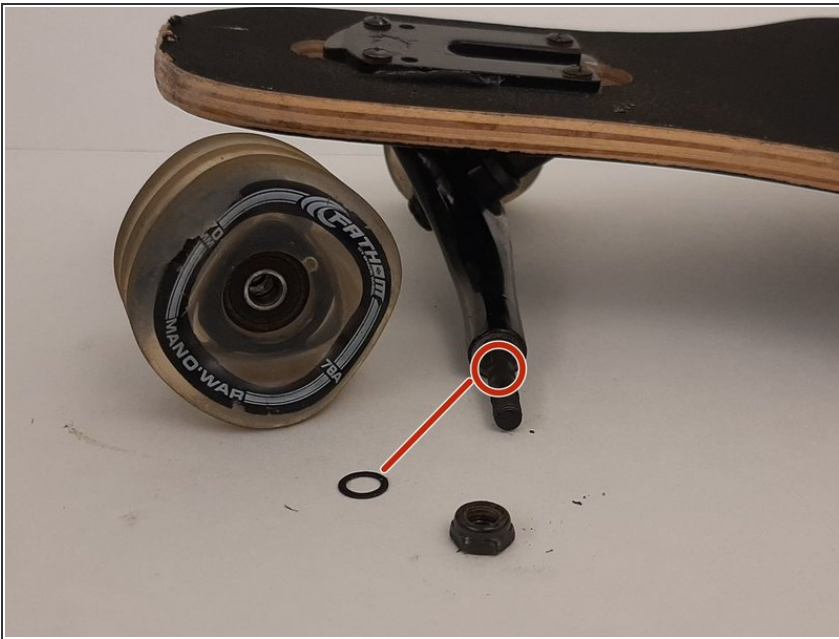

- Remove the wheel and the outside spacer from the board.
- ⓘ The spacer is the tiny circle between the axle and the wheel that keeps them from rubbing/grinding.

Step 3



- Use the pointy end of the small tool that comes with the Skate Tool and insert it under the bearing (look at the red arrow) to pry (and we mean **PRY**) out one of the bearings.
- We recommend starting with the bearing on side of the wheel that stays closest to the board and prying in the direction of the green arrow.

Step 4



- Remove the spacer that sits between the bearings on the inside of the wheel.
- Pry out the other bearing.
- i* We used our fingers. The tool can also be used, whichever you find easier. We recommend pushing it out from the inside.
- i* The last picture is all the parts that you should have at this point.

Step 5



- Insert one of the new bearings into the wheel. It should not matter what way you put it in unless they are specialty bearings.
- ⓘ Use your fingers to push it in, the tool can also be used, whichever you find easier.
- Push until it stops against the built in stopper within the wheel.

Step 6



- Place in the spacer that goes between the bearings on the inside.
- ⓘ Make sure the spacer is standing upright (shown in the second picture).
- Repeat step 5 to insert the other bearing on the other side of the wheel.

Step 7



- Put the outside spacer back on the axle of the board.
- Put the wheel back on in the proper orientation.
- i* The orientation depends on the wheel, but typically the decals face outward from the board.
- i* You might need to use the pointed end on the small tool to move spacer on inside of the wheel to fit on the axle.

Step 8

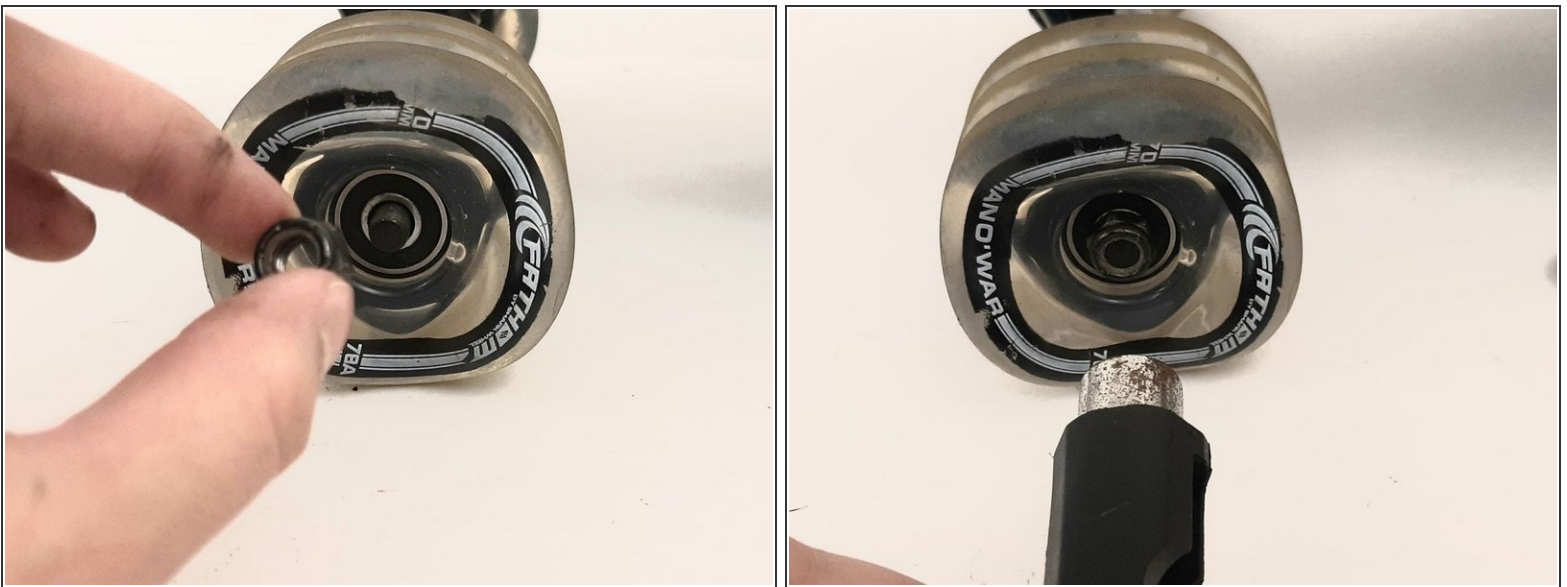

- Using the 1/2" side of the Skate Tool, screw the nut back on the axle to hold the wheel in place.

Step 9

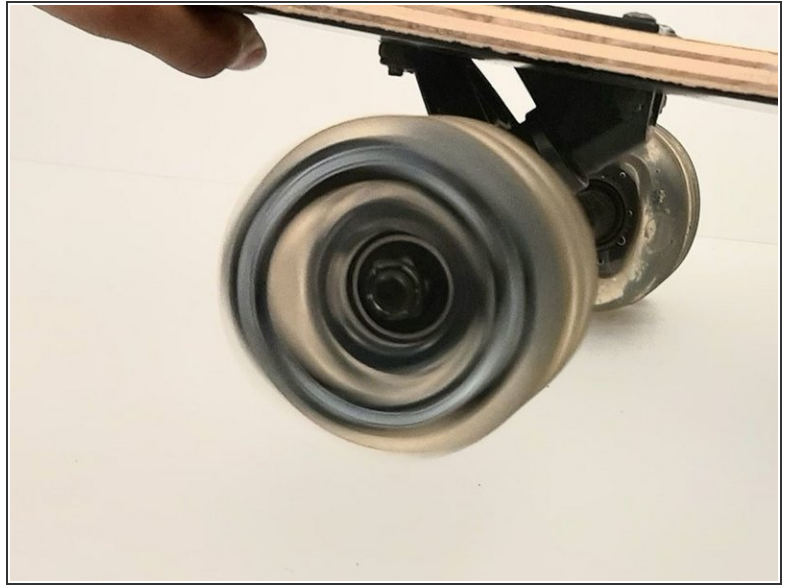
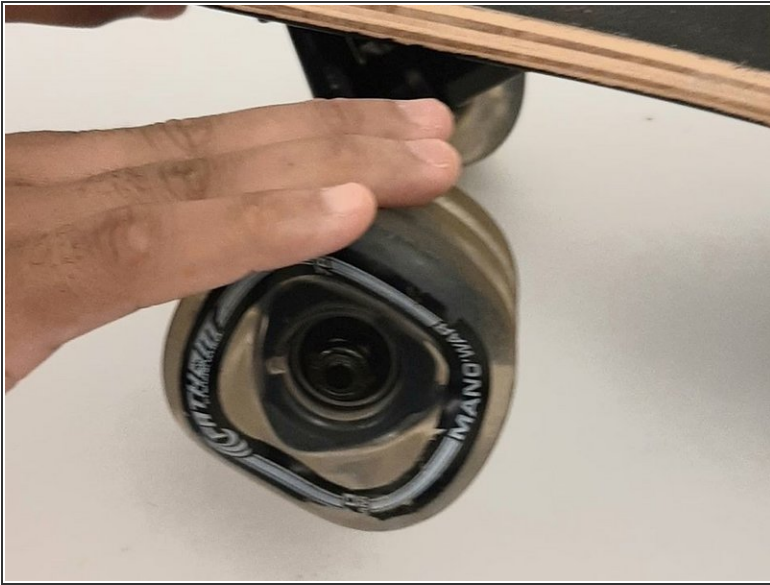

- Test the wheel by spinning it on the board to check that it moves freely.
- ⓘ If the wheel does not spin freely, the nut may be too tight. Loosen it just a little bit.

To replace the bearings on the other wheels, repeat steps.