



# Air Filter Removal

A pre-requisite only guide for removing the air filter and air box in order to complete other repairs.

Written By: Craig Lloyd



---

## INTRODUCTION

This is a pre-requisite only guide for removing the air filter and air box in order to complete other repairs.



### TOOLS:

- [10mm Socket](#) (1)
  - [Socket Wrench](#) (1)
  - [Snap Ring Pliers](#) (1)
  - [Nitrile Gloves](#) (1)
-



## Step 1 — Remove the Air Filter Cover

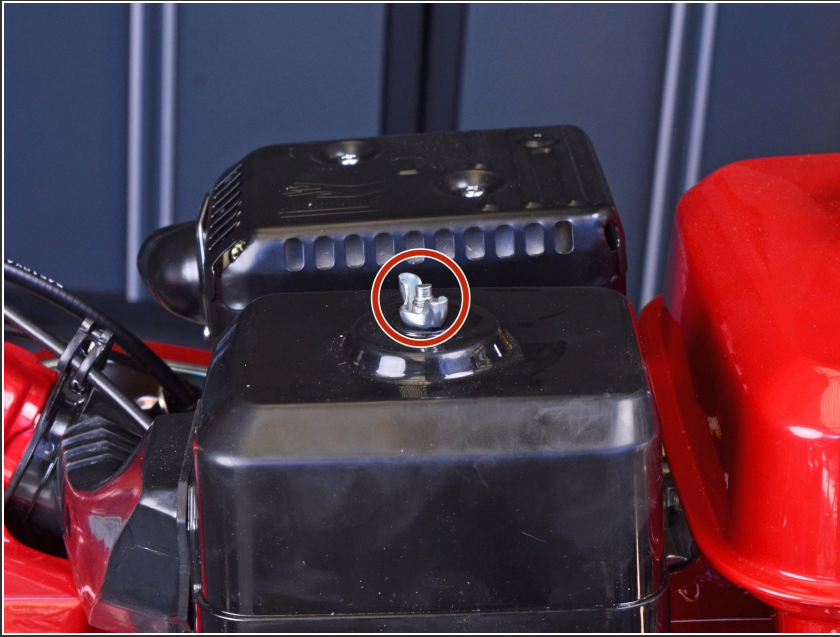

- Use your fingers to unscrew and remove the wing nut securing the air filter cover to the air filter elbow.

## Step 2

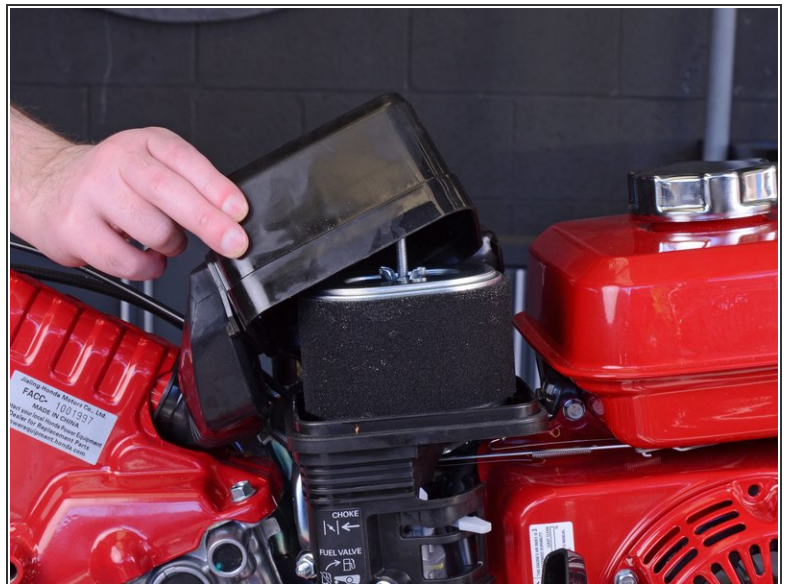
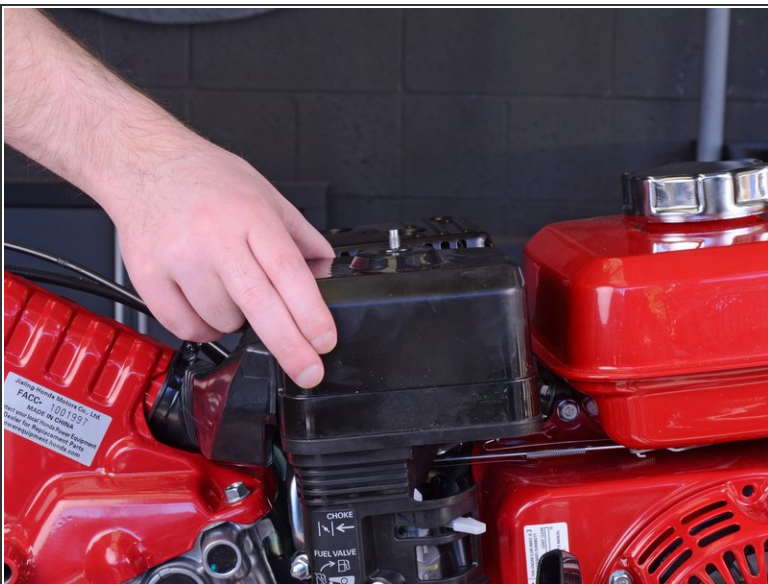

- Lift up and remove the air filter cover to reveal the air filter.
- ⓘ The air filter cover will still be attached to the tiller by a flexible hose. You can push the cover to the side while you continue to work on the tiller, or follow the next two steps to completely remove the cover.

### Step 3 — Detach the Air Filter Cover



- i** The next two steps are optional, but they will make it easier to work on the tiller from here on out.
- Squeeze the metal clip on the inside of the air filter cover and remove it.

### Step 4



- Hold onto the air filter hose and pull on the air filter cover to remove it.



## Step 5 — Remove the Air Filter

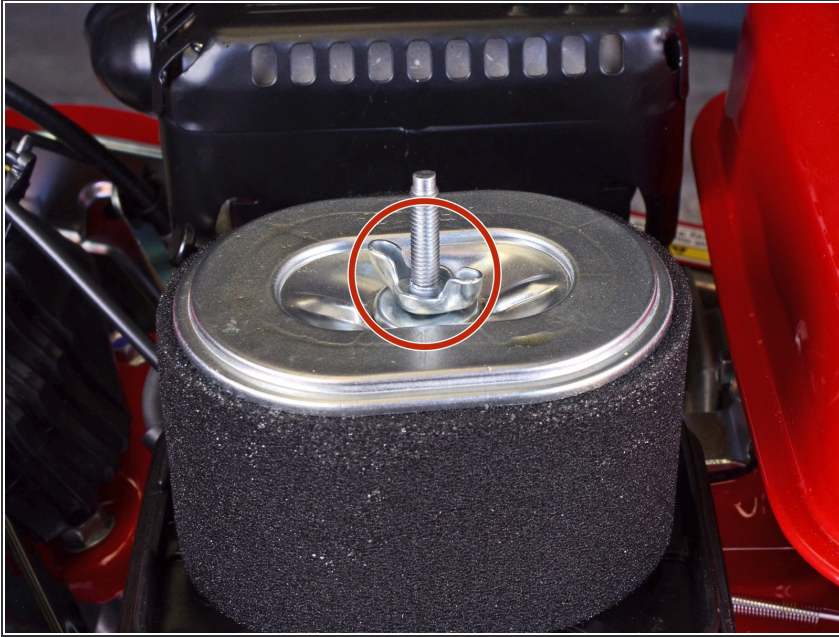

- Use your fingers to unscrew and remove the wing nut securing the air filter to the air filter elbow.

## Step 6



- ⓘ Wear gloves or use a rag during this step, as the air filter is coated with oil.
- Lift the air filter straight up off the elbow, making sure it clears the threaded rod.

## Step 7 — Remove the Air Filter Elbow

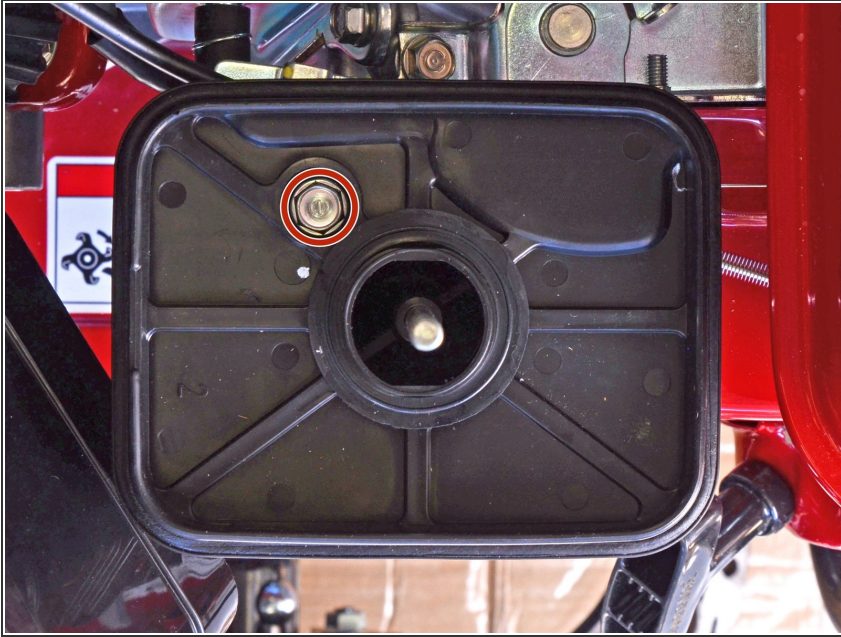

- Use a 10 mm socket and socket wrench to remove the 25.5 mm-long bolt securing the air filter elbow to the tiller.

## Step 8

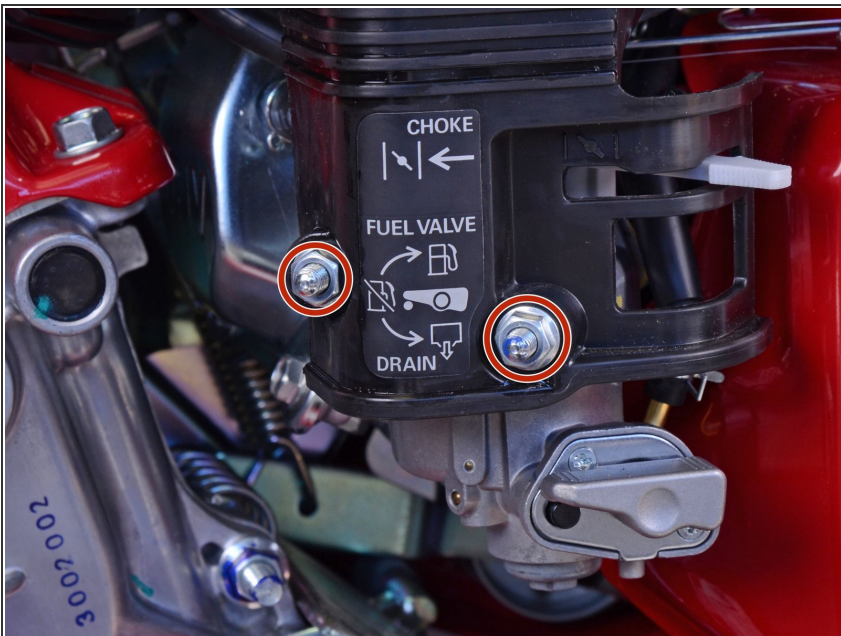

- Use a 10 mm socket and socket wrench to remove the two nuts securing the air filter elbow to the carburetor's threaded rods.



## Step 9

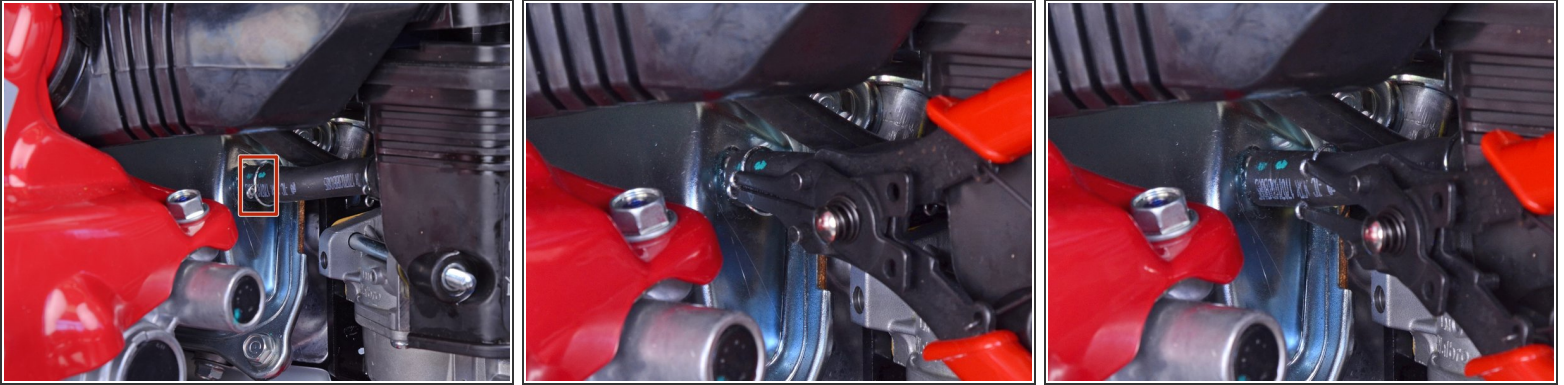

- Use a pair of snap ring pliers to loosen the spring hose clamp on the breather tube, pulling it out 2-3 cm so it's not clamping onto the end of the tube.

## Step 10

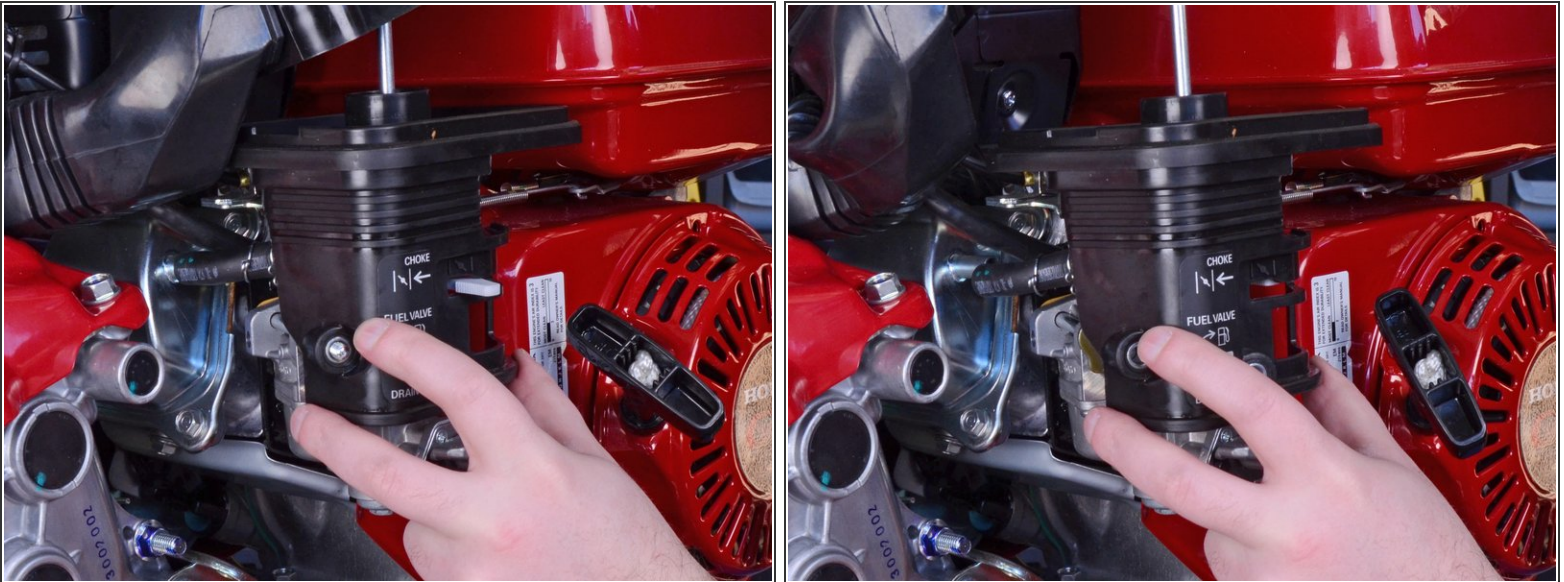

- Pull the air filter elbow straight off, making sure it clears the carburetor's threaded rods.
- ⓘ As you remove the elbow, you may need to use your other hand to remove the breather tube from the engine's valve cover.

To reassemble your device, follow these instructions in reverse order.