



Honda FC600 Tiller Tine Replacement

A guide for replacing a damaged or worn tine on the Honda FC600 tiller.

Written By: Craig Lloyd



INTRODUCTION

Follow this guide to replace a damaged tine on the Honda FC600 tiller.



TOOLS:

- [14mm Wrench](#) (1)



PARTS:

- [Honda Tine B, Rotary 72465-733-750](#) (1)
- [Honda Tine A, Rotary 72461-733-750](#) (1)

Step 1 — Remove the Spark Plug Cap

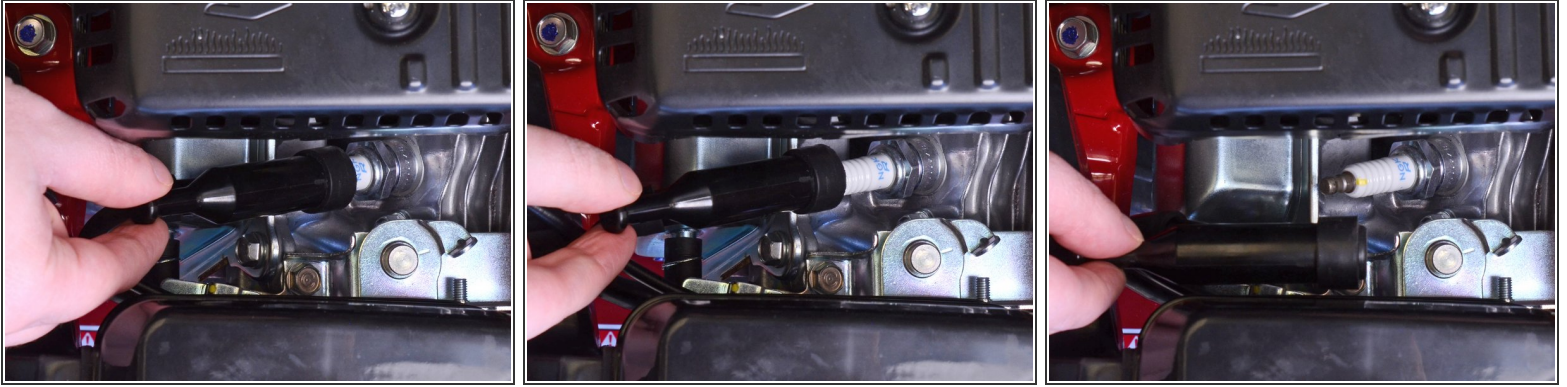



 Before you begin, it's important that you completely cut power to the tiller by disconnecting the spark plug. This will prevent the engine from accidentally starting up while you're working on the tiller.

- Grab the spark plug cap and pull it straight out to disconnect the spark plug from the engine.

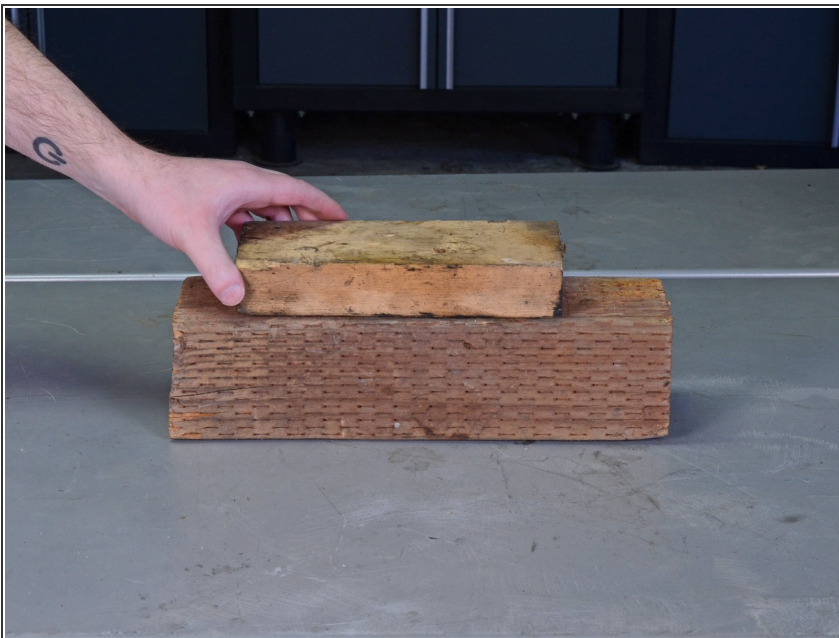
Step 2 — Prop Up the Tiller



-  The next two steps demonstrate how to prop up the tiller to work on the tines.
- Set down a block (or blocks) of wood onto your work surface.
-  Make sure the wood blocks are narrow enough to fit in between the left- and right-side tines.

Step 3

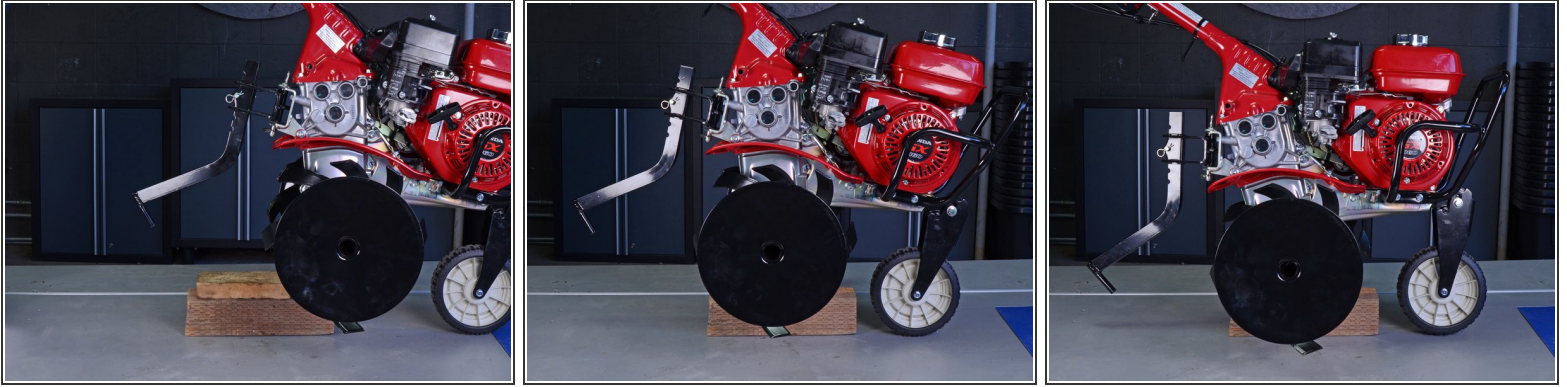

- Lift and roll the tiller over the wood block until the center of the tine axle is hovering over the wood block.
- Gently set the tiller down so that the center of the tine axle rests on the wood block.
- ① You may need to lean the tiller to one side to make sure the tines on the other side are completely off the work surface.

Step 4

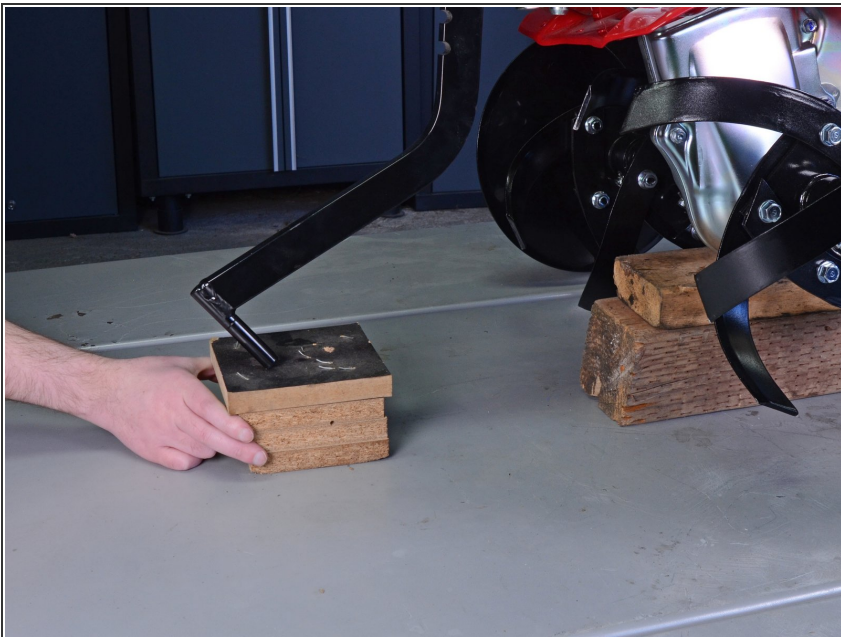

- Place a block (or blocks) of wood under the tiller's drag bar to prevent the tiller from leaning back.

Step 5 — Remove the Tine

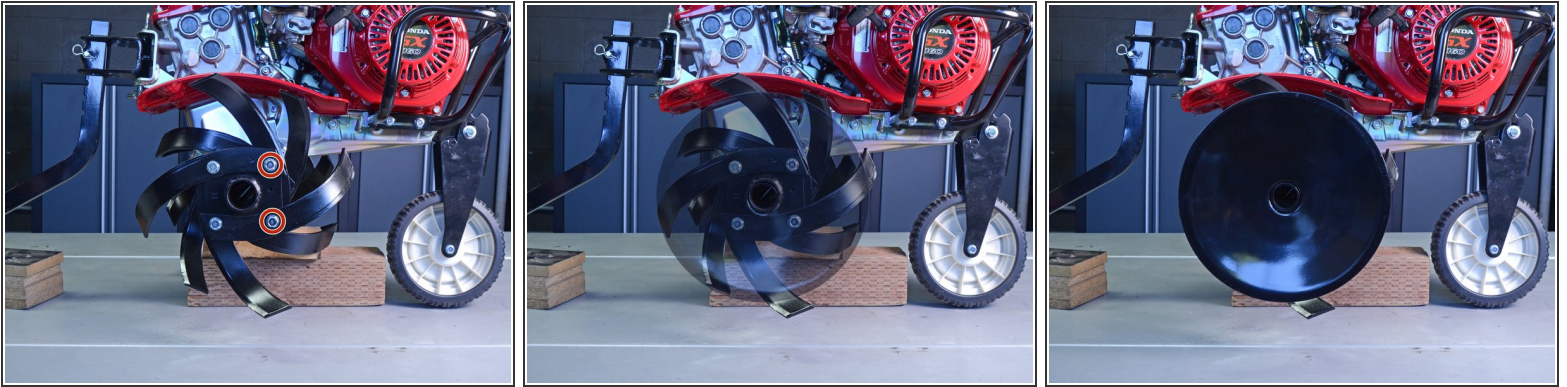

- Remove the two 14 mm nuts securing the tine to the mounting bracket.
- ⓘ It is not required to remove the side disc.
- ⓘ Depending on which tine you're replacing, you may need to remove different nuts.

Step 6

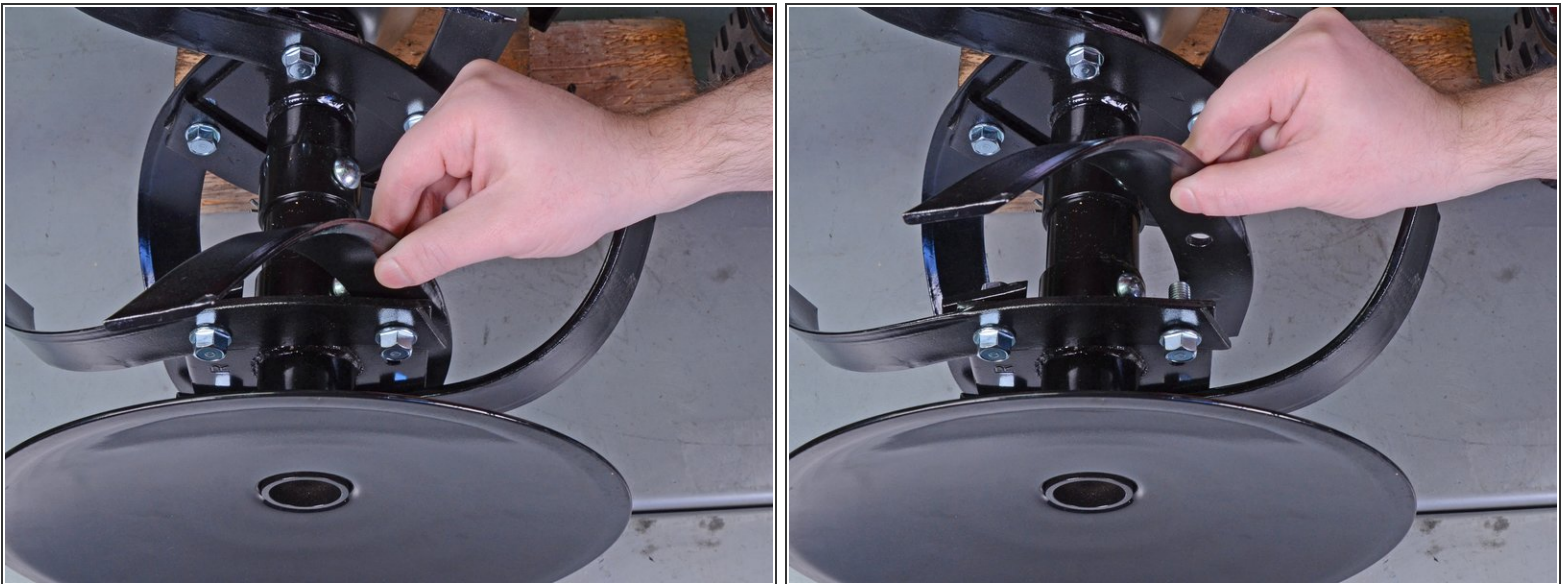

- Grab the tine and pull it straight off of the mounting bracket.
- ⓘ Removing the bolts is not required.

To reassemble your device, follow these instructions in reverse order.

This document was generated on 2020-11-28 07:51:26 AM (MST).

